

# INSTALLATION INSTRUCTION

## I CAN'T BELIEVE IT'S NOT RECESSED

### FM-616G2-9CS

# WAC

#### WARNING

IMPORTANT: NEVER attempt any work without shutting off the electricity.

- Read all instructions before installing.
- System is intended for installation by a qualified electrician in accordance with the National Electrical Code and local regulations.
- Go to the main fuse box, or circuit breaker. Place the main power switch in the "OFF" position and unscrew the fuse(s) or switch "OFF" the circuit breaker switch(es) that control the power to the fixture or room that you are working on.
- Place the wall switch in the "OFF" position.
- Supply conductors (Power Wires) Connecting the fixture must be rated minimum 90°C. If uncertain, consult an electrician.

#### CAUTIONS

- These luminaires (fixtures) are designed to meet the latest NEC requirements and are listed in full compliance with UL 1598.
- Before attempting installation, check your local electrical code, as it sets the wiring standards for your locality.

#### INSTALLATION

Uses 4" junction box or a combination 3/0-4/0 electrical box.

1. Attach two mounting screws into outlet box leaving enough of screw exposed to engage keyholes in the top of fixture (**Fig. 1**).

Note: Keyhole mounting distance is 3.5" (**Fig. 2**).

2. Provide electrical service according to the "National Electrical Code" or your local electrical code to the outlet box.
3. Connect supply wires to fixture wires and insulate with proper wire nuts.
4. Connect incoming ground wire to fixture ground wire (green or bare).
5. Connect incoming common wire to fixture common (white).
6. Connect incoming hot wire to fixture black wire.
7. Raise the fixture to the junction box, guiding screw and tighten screws through keyhole slots.
8. Snap the keyhole covers into place to hide mounted screws.

#### LENS INSTALLATION

Secure the lens over the LED module by snapping it into place.

#### SETTING COLOR TEMPERATURE

Use the switch on the side of the fixture to selected desired color temperature.

Fig. 1

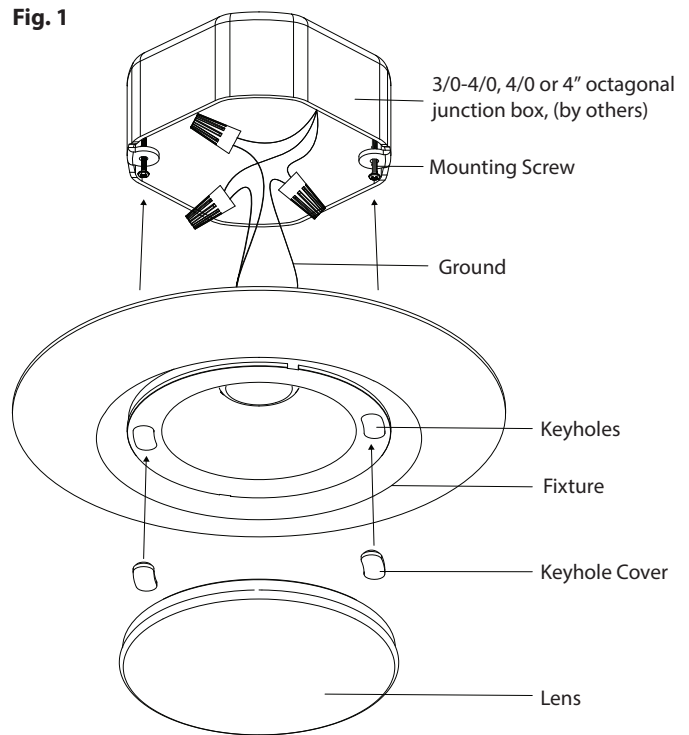

Fig. 2

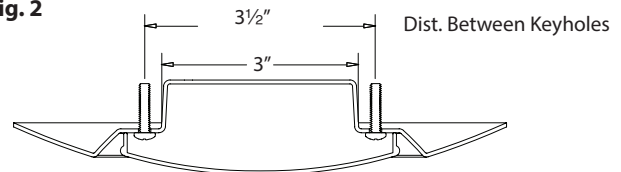
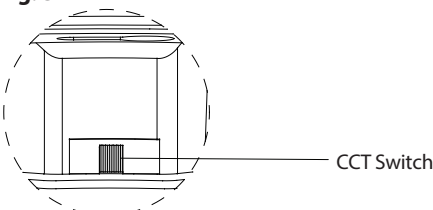

Fig. 3



# INSTALLATION INSTRUCTION

## I CAN'T BELIEVE IT'S NOT RECESSED

### FM-616G2-9CS

# WAC

#### Installation onto existing 5 inch or 6 inch recessed housings

1. Insert the pre-installed screws on the retrofit kit into the keyholes on the back of the fixture. Turn the fixture until the screws hit the smaller side of the keyhole. **(Fig. 1)**
2. Remove the snap-on front diffuser and tighten the retrofit kit screws from the front of the fixture. Place on the silicon keyhole covers and reinstall the diffuser. **(Fig. 2)**
3. Screw E26 "medium screw base" socket adapter into socket in housing. **(Fig. 3)**
4. Insert the fixture wires into male connector of the socket adapter assembly. Plug the female connector onto the male connector. **(Fig. 4)**
5. Squeeze the torsion springs together as shown and install into torsion spring brackets inside the housing. **(Fig. 5)**
6. Tuck all wires into to the housing and carefully push the fixture into the housing. **(Fig. 5)**

**Fig. 1**

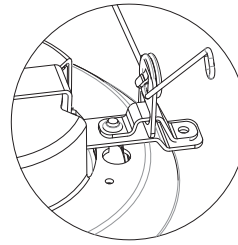

**Fig. 2**

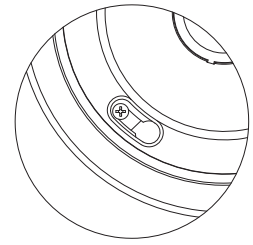

**Fig. 3**

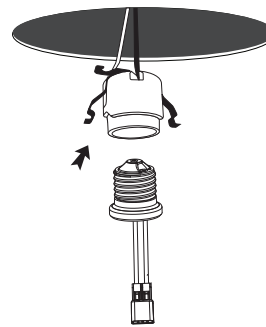

**Fig. 4**

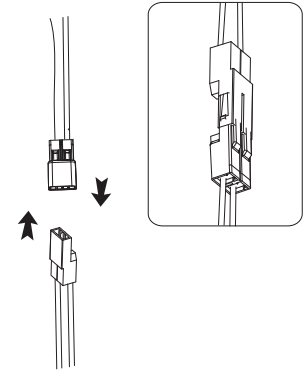

**Fig. 5**

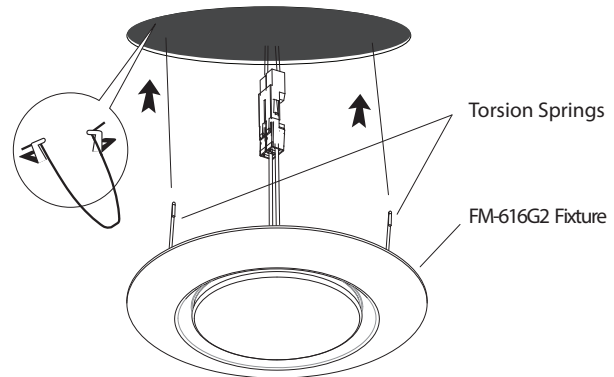

#### ACCESSORIES BAG (A-FM616):



Wire Connector  
Qty: 3 pcs  
P3



Junction Box Screw  
Qty: 2 pcs  
#8-32, \* 3/4"  
Stainless Steel



Keyhole Cover  
Qty: 2 pcs

wacighting.com  
Phone (800) 526.2588  
Fax (800) 526.2585

Headquarters/Eastern Distribution Center  
44 Harbor Park Drive  
Port Washington, NY 11050

South East Distribution Center  
1600 Distribution Ct  
Lithia Springs, GA 30122

Central Manufacturing Facility  
1700 South J Elmer Freeway  
Suite 100  
Cedar Hill, TX75104

Western Distribution Center  
1750 Archibald Avenue  
Ontario, CA 91761