

INSTALLATION INSTRUCTION

LED DISC

FM-306-9CS

WAC

WARNING

IMPORTANT: NEVER attempt any work without shutting off the electricity.

- Read all instructions before installing.
- System is intended for installation by a qualified electrician in accordance with the National Electrical Code and local regulations.
- Go to the main fuse box, or circuit breaker. Place the main power switch in the "OFF" position and unscrew the fuse(s) or switch "OFF" the circuit breaker switch(es) that control the power to the fixture or room that you are working on.
- Place the wall switch in the "OFF" position.
- Supply conductors (Power Wires) Connecting the fixture must be rated minimum 90°C. If uncertain, consult an electrician.

CAUTIONS

- These luminaires (fixtures) are designed to meet the latest NEC requirements and are listed in full compliance with UL 1598.
- Before attempting installation, check your local electrical code, as it sets the wiring standards for your locality.

INSTALLATION

Over 3" or 4" junction box

1. Attach two mounted screws into outlet box leaving enough of screw exposed to engage keyholes in the top of light fixture. (**Fig.1 , Fig.2**)
2. Provide electrical service according to the "National Electrical Code" or your local electrical code to the junction box.
3. Connect supply wires to fixture wires and insulate with proper size wire nuts (**Fig.1**)
4. Connect incoming ground wire (green or bare) to fixture ground wire (green or bare).
5. Connect incoming common (white) wire to fixture common (white).
6. Connect incoming hot (typically black) wire to fixture black wire.
7. Raise the light fixture to the junction box and tighten screws.

SETTING COLOR TEMPERATURE

Once the fixture is fastened, use the switch on the side of the fixture to selected desired color temperature.

LEDS INSTALLATION

Twist the lens clockwise on light fixture metal enclosure and lock the lens in place.

Fig. 1 (3-0 / 4-0 combination box shown)

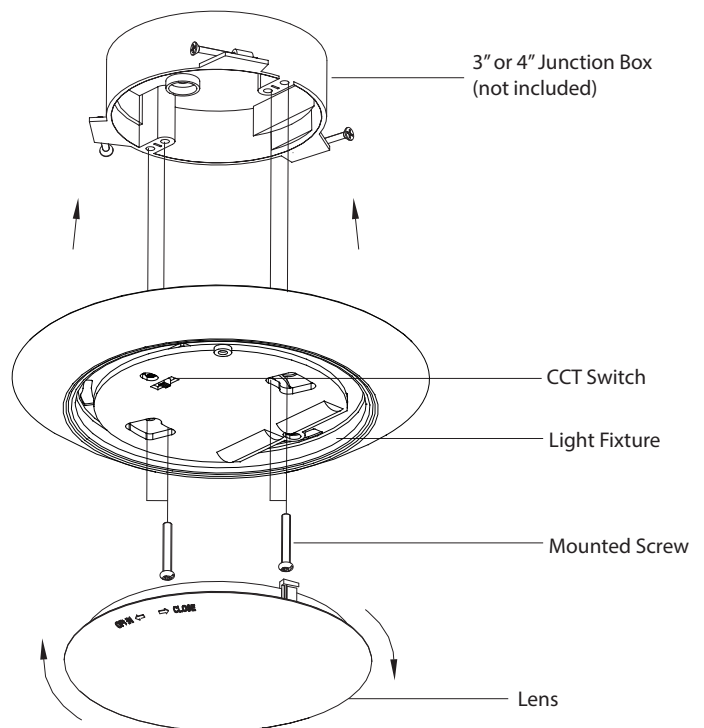
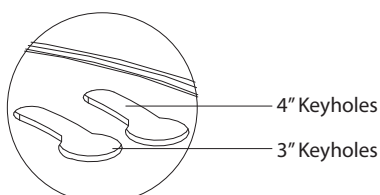

Fig. 2



wacighting.com
Phone (800) 526.2588
Fax (800) 526.2585

Headquarters/Eastern Distribution Center
44 Harbor Park Drive
Port Washington, NY 11050

Central Distribution Center
1600 Distribution Ct
Lithia Springs, GA 30122

Western Distribution Center
1750 Archibald Avenue
Ontario, CA 91760

INSTALLATION INSTRUCTION

LED DISC

FM-306-9CS

WAC

Installation onto existing 5 inch or 6 inch recessed housings

1. Screw E26 "medium screw base" socket adapter into socket in housing. **(Fig. 2)**
2. Plug the female connector of the disc light onto the male connector of the socket adapter assembly. **(Fig. 3)**
3. Squeeze the torsion springs together as shown and install into torsion spring brackets inside the housing. **(Fig. 4)**
4. Tuck all wires into to the housing and carefully push the disc light into housing. **(Fig. 4)**

LENS INSTALLATION

Twist the lens clockwise on disc light metal enclosure and lock the lens in place.

Wet Location Rated

1. To prevent moisture from entering the outlet box and causing a short, use clear caulking (i.e. indoor/outdoor silicone sealant) to outline the outside of fixture canopy where it meets the wall. **(Fig. 5)**

Fig. 5 Sealing

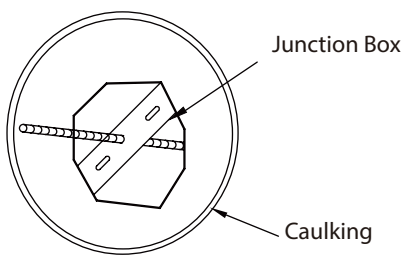

Fig. 2

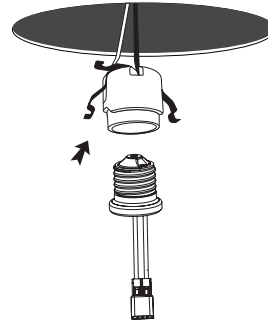

Fig. 3

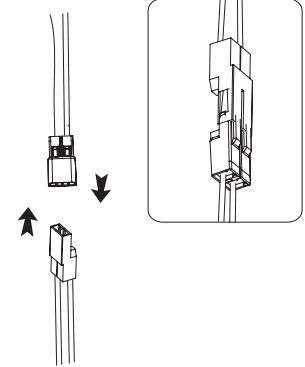
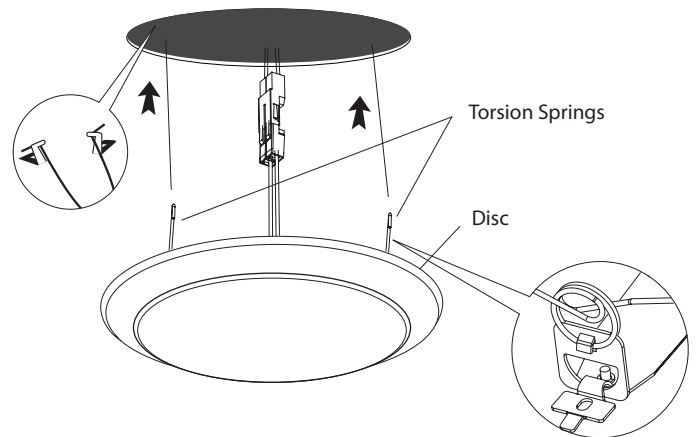

Fig. 4



Caution

Make sure that tab in bracket should be positioned inward.

